

English-1

#### Drills with Cylindrical Shafts

Tools with cylindrical shafts can be mounted with the key or keyless chuck (optional accessory) and the associated adapter (optional accessory).

Set the impact stop switch 6 to "Drilling" (only at a standstill).

Clean and lightly grease the adapter shaft.

Insert the assembled chuck by twisting it into the tool holder until it latches. The chuck locks itself. Check the locking by pulling on the chuck.

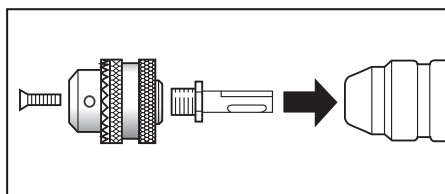

#### Screwdriving (GBH2-24 DSR)

For screwdriving, the universal bit holder with SDS-plus shaft (optional accessory) must be used.

- Set the direction of rotation to right rotation.
- Control the speed with the On/Off switch 4.

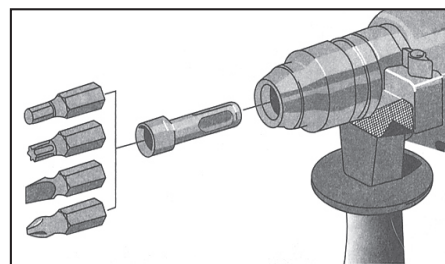

#### Dust Extraction

The dust extraction device prevents large amounts of dust from accumulating, keeps the breathing air dust-free and facilitates disposal.

The machine can be plugged directly into the receptacle of a Bosch general-purpose vac with remote starting control. The vac starts automatically as soon as the machine is switched on.

#### Dust Extraction Attachment

Mount the dust extraction attachment (optional accessory) and connect the vacuum cleaner. The dust extractor springs back to the predetermined drilling depth. By doing this, the dust extractor head is always held near the surface.

#### Maintenance and Cleaning

Before any work on the machine itself, pull the power plug.

For safe and proper working, always keep the machine and the ventilation slots clean.

Keep the tool holder clean at all times.

Have the customer service department change a damaged dust protection cap immediately.

Should the machine fail in spite of careful manufacturing and testing, its repair should be carried out by a Bosch power tools authorized service agent.

For all correspondence and spare parts orders, always include the 10-digit order number of the machine!

#### Environmental Protection



Recycle raw materials instead of disposing them as waste.

The machine, its accessories and packaging materials should be sorted for environmentally-friendly recycling.

These instructions are printed on chlorine-free recycled paper.

The plastic components are labeled for categorized recycling.

# HAMMER DRILL

## 20mm 24mm

### Handling instructions

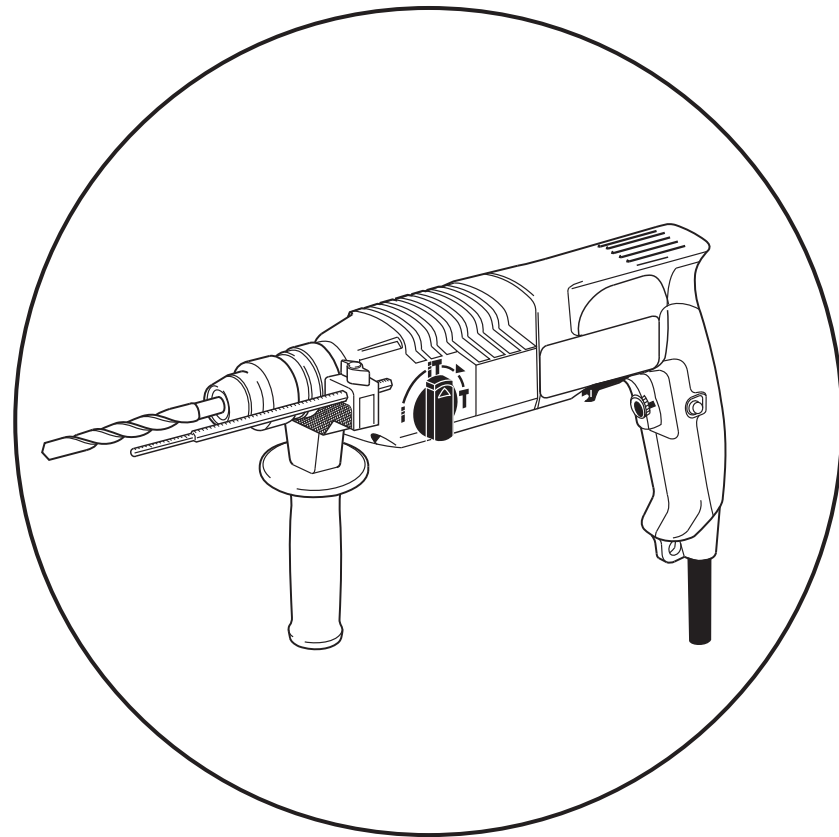

Read through carefully and understand these instructions before use.

#### Tool Specifications

Rotary Hammer	GBH 2-24DS	GBH 2-24DSE	GBH 2-24DSR
Part number	0 611 226 0..	0 611 226 5..	0 611 226 8..
Rated power	[W]	1150	1150
Output power	[W]	360	360
Speed control		•	•
Right/Left rotation		•	•
Rated speed			
- Right rotation	[rpm]	870	0-870
- Left rotation	[rpm]	-	0-500
Impact rate	[bpm]	4850	0-4850
Impact energy per stroke	[J]	2.2	2.2
Tool holder		SDS-plus	SDS-plus
Spindle neck diameter $\varnothing$	[mm]	43	43
Drilling output:			
- Masonry (core bit) max.	[mm]	65	65
- Stone, Concrete max.	[mm]	24	24
- Wood max.	[mm]	30	30
- Steel max.	[mm]	13	13
Weight (without optional extras) approx.	[kg]	2.4	2.4
Safety class		II	II

#### Operating Controls

- 1 Dust protection cap
- 2 Locking sleeve
- 3 Locking button for On/Off switch
- 4 On/Off switch
- 5 Reversing switch (GBH 2-24DSR)
- 6 Impact stop switch
- 7 Release button
- 8 Auxiliary handle
- 9 Depth stop

Not all the illustrated or described accessories are included as standard delivery.

#### Noise/Vibration Information

Measured values determined according to EN 50 144.

The A-weighted noise levels of the tool are typically: Sound pressure level: 88 dB (A); sound power level: 101 dB (A).

#### Wear ear protection!

The weighted acceleration is typically 11 m/s<sup>2</sup>

#### Intended Use

The machine is intended for hammer drilling in concrete, brick and stone. It is also suitable for drilling without impact in wood, metal, ceramics and plastic. Machines with electronic control and right/left rotation are also suitable for screwing and thread cutting.



#### For Your Safety

Working safely with this machine is possible only when the operating and safety information is read completely and the instructions contained therein are strictly followed. In addition, the general safety notes in the enclosed booklet must be observed. Before using for the first time, ask for a practical demonstration.

If the cable is damaged or cut through while working, do not touch the cable and pull the plug immediately. Never use the machine with a damaged cable.

Wear protective glasses and ear protection.

If you have long hair, wear a protective helmet. Work only with close-fitting clothes.

Do not drill, saw or cut in blind areas where there could be hidden electric, gas or water lines. Use the appropriate detectors to find these lines in the work area or call the local utility company for assistance. Touching electric lines may cause fire or electric shock. Striking a gas line will probably result in an explosion. Breaking into a water pipe will cause property damage or may cause an electric shock.

Hold electric tools by their insulated handles whenever they could possibly touch a hidden wire or their own cords. Touching a "live" wire can transfer the voltage to the exposed metal parts of the tool and give the operator an electric shock.

Connect machines used outdoors via a residual current device (RCD) with a maximum tripping current of 30 mA. Use only extension cables that are intended for outdoor use.

Use the machine only with the auxiliary handle 8.

Always direct the cable to the rear away from the machine.

Do not carry or hang up the machine by the cable.

Insert the power plug only when the machine is switched off.

Place the machine on the screw/nut only when switched off.

When working with the machine, always hold it firmly with both hands and make sure you are in a secure standing position.

For screws, work using the first gear or with a low speed.

Be careful when screwing in long screws, as they can slide off.

Always switch off the machine and allow it to come to a stop before putting it down.

Never allow children to use the machine.

Bosch can only guarantee a flawless functioning of the machine if the original accessories intended for it are used.

#### Changing the Tool

Before any work on the machine itself. Pull the power plug.

With the SDS-plus tool holder, simpler and easier tool changing is possible without additional aids.

Grease the shank end of the tool regularly.

The dust protection cap 1 prevents most of the drilling dust to enter into the machine during its operation. When inserting tools, take care not to damage the dust protection cap 1.

Have the customer service department change a damaged dust protection cap immediately.

The system requires the SDS-plus tool to rotate freely, which results in a radial eccentricity when the machine is idling. This does not affect the accuracy of the drill hole, as the bit is automatically centered during drilling.

#### Inserting

Clean and grease the shank end of the tool.

Insert the tool by twisting it into the tool holder until it latches itself. Check the latching by pulling on the tool.

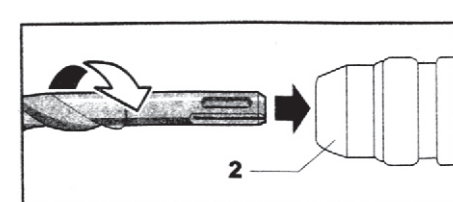

#### Removing

Push back the locking sleeve 2 of the tool holder and remove the tool.

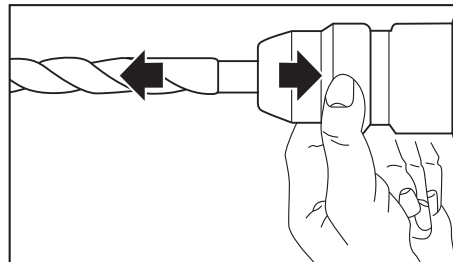

#### Auxiliary Handle/Depth Stop

Use the machine only with the auxiliary handle 8.

Loosen the handle by turning to the left. Rotate the auxiliary handle 8 and adapt to the working position.

Afterwards, retighten the handle firmly.

The drilling depth can be set with the depth stop 9. The grooving on depth stop 9 must point upwards.

#### Initial Operation

Always use the correct voltage: The voltage of the power source must agree with the values on the nameplate of the machine.

#### Switching On and Off

To start the unit, push the On/Off switch 4 and keep it pushed.

Lock the pushed On/Off switch 4 by pressing the lock-on button 3.

To switch the unit off, release the On/Off switch 4 of push and release it then.

#### Infinitely Variable Speed Control (GBH 2-24DSE/DSR)

Light pressure on the On/Off switch 4 results in low rotational speed, thus allowing drilling to begin in a smooth, controlled manner. Speed increases with additional pressure on the switch.

#### Changing the Rotational Direction (GBH 2-24DSR)

The direction of machine rotation can be selected with the reversing switch 5.

For better loosening of completely screwed in threaded connections, the left rotation speed is limited to 500 RPM.

For safety reasons, the On/Off switch 4 cannot be locked with the locking button 3 during left rotation.

#### Speed Table

The values in the Table are recommendations.

Area of Application	Impact Stop Switch	Speed control GBH 2-24DSE/DSR
Impact Drilling - Stone/Concrete		
Drilling - Wood/Steel		
Screwdriving		

#### Impact Stop Switch

Operate the impact stop switch 6 only when at a standstill.

While pressing the release button 7, set the impact stop switch 6 to the desired position.



#### Drilling



#### Hammer drilling



#### Overload Clutch

If the drill becomes caught or jammed, the drive to the drill spindle is interrupted.

Due to the forces occurring as a result of this, always hold the machine firmly with both hands and provide for a secure stance.



English-2